

12 1st
Insert Valve into Sideburner Tube and snap valve cup into bottom of shelf (see inset for proper engagement). Place Sideburner Knob.

2nd
Place "AAA" battery into module, secure with Button.

3rd
Attach long wire from beneath console to electrode beneath Sideburner.

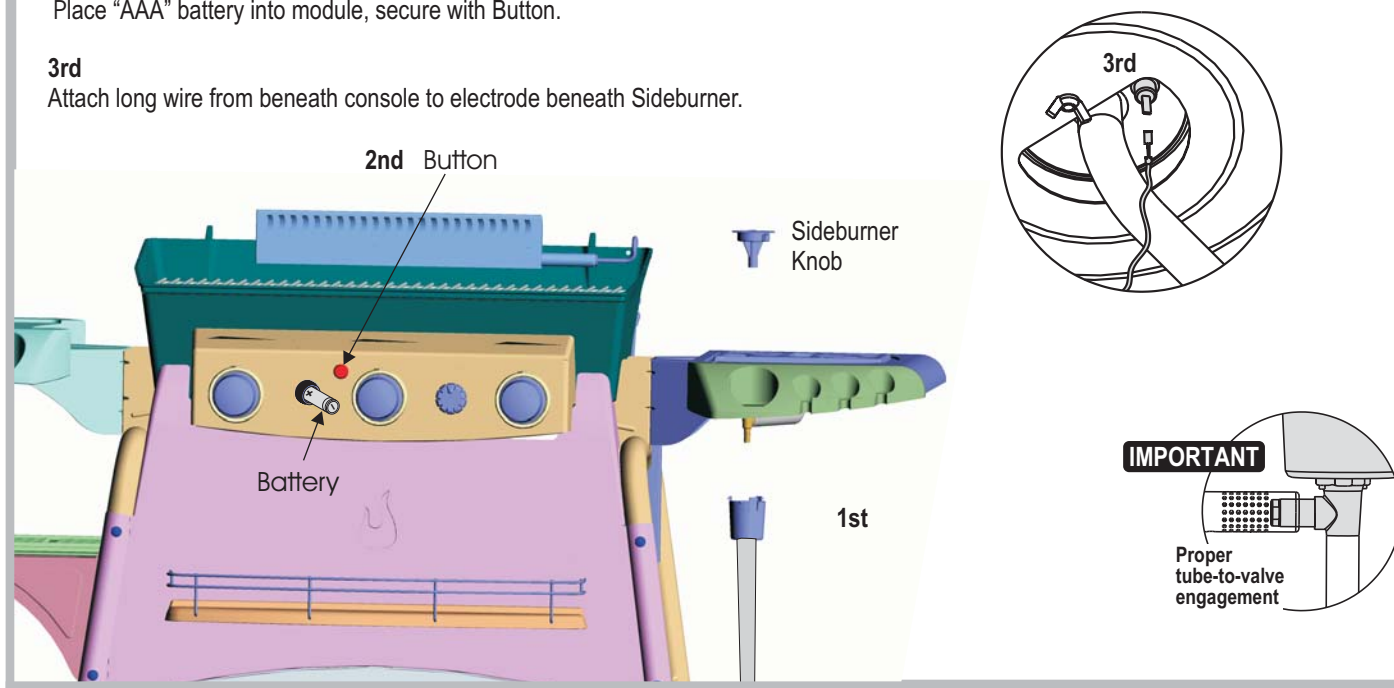

13 Items to Assemble:
1 Grease Clip

Hang grease clip from center of grill bottom.
Use an empty soup can (not included) to hang from grease clip.

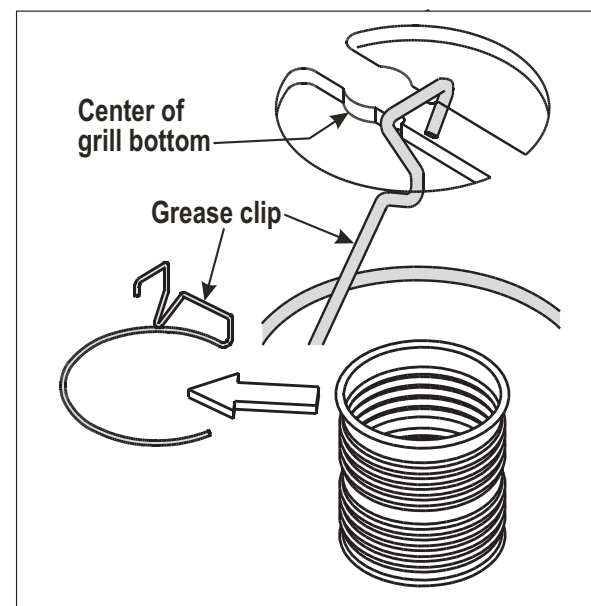

CAUTION

• Failure to install can in clip will cause hot grease to drip from bottom of grill with risk of fire or property damage.

14 Items to Assemble:
1 Chain with Coupling
1 Match-Holder

Remove coupling from chain.
Place end of chain through hole, reattach coupling to end of chain.
Thread eyelet on other end of chain into loop of match holder.

See Use & Care Manual for "Match Lighting Instructions"

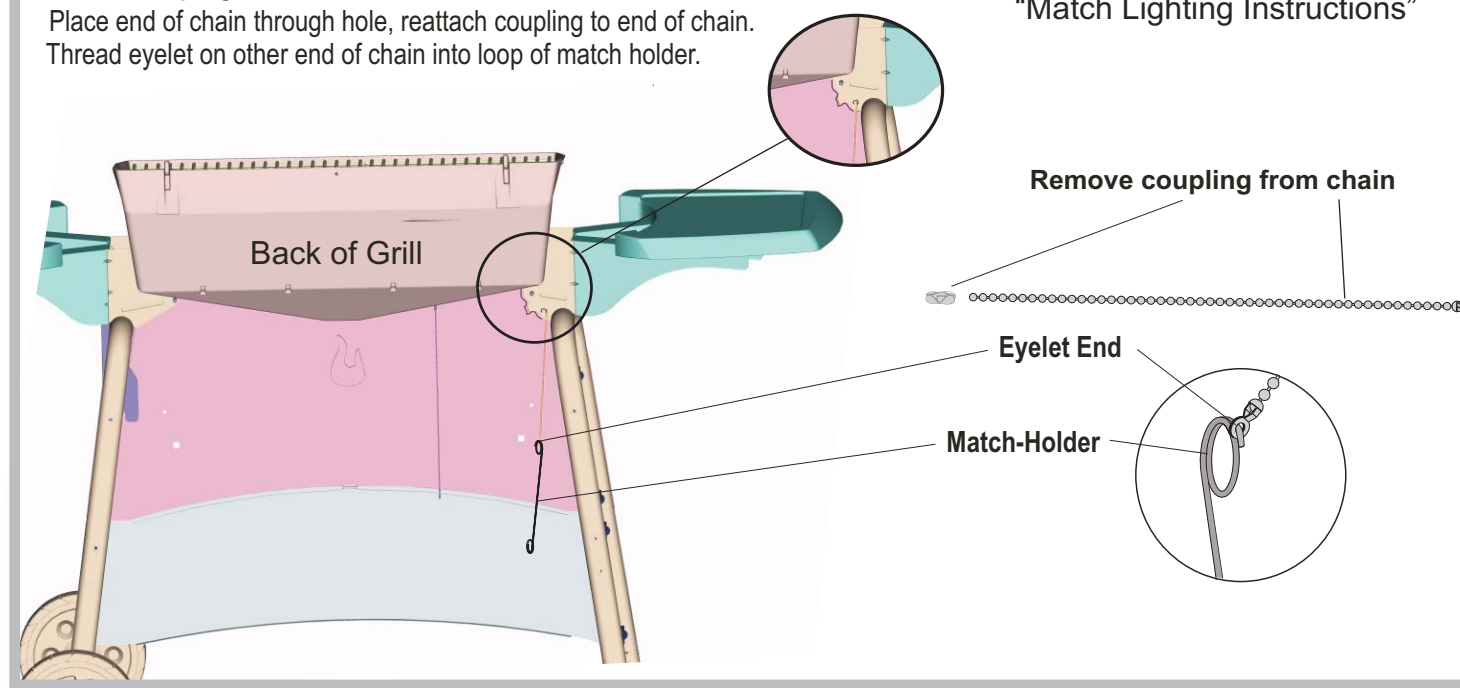

15 Items to Assemble:
1 LP Tank

Loosen wing-nut on tank retainer.
Center base of tank in notches between wheels.
Lower tank retainer onto tank and tighten the wing-nut.

LP tank is shipped empty. Fill and leak check before attaching to grill and regulator.

See Use and Care to perform the "Burner Flame Check" and important safety instructions before using

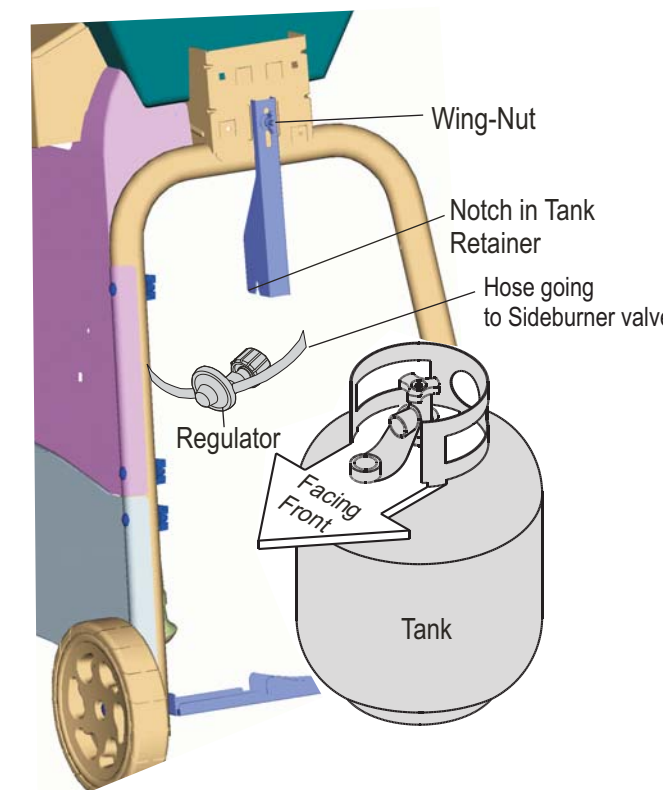

CAUTION

• Tank collar opening must face to front of cart once tank is attached.
• Failure to install tank correctly may allow gas hose to be damaged in operation, resulting in the risk of fire.

Parts List - Model 4638263

Key Qty.	Description	Part #
A	1	Condiment Wire 4151005
B	3	Tent Frame 4151014
C	1	Deep Dish 4152039
D	1	Cooking Grid, 12" 4152054
E	1	Cooking Grid, 15" 4152055
F	2	Wheel 4154417
G	1	Sideburner Toolholder. 4154519
H	1	Condiment Tray 4154528
I	1	Sideburner Grate 4156179
J	1	Chef's Delite 4156455
K	1	LP Tank. 4158015
--	1	Spit Rod 4158063
L	3	Burner Tent 4500226
M	1	Rotisserie Burner 4500249
N	1	Tank Retainer 4503105
O	1	Storage Shelf 4503107
P	1	Tank Support. 4503114
Q	1	Upper Panel 4503119
R	1	Lower Panel 4503121
--	1	Rotisserie 4507294
S	2	#10x1/2" Screw, Self-tap 4080043
T	2	Pivot Pin 4080066
U	3	3/16 Pal Nut 4153096
V	1	Ignitor Wire 4153184
W	2	Caster 4154261
X	2	Caster Socket 4154514
Y	2	Hitch Pin 4156515
Z	2	Carry-over Tube 4500228

Key Qty.	Description	Part #
AA	1	Right Leg 4503147
BB	1	Left Leg 4503148
CC	1	Console Assembly 4530047
DD	1	Ignitor 4153186
EE	1	Rotisserie Ignitor Wire 4153806
FF	1	Sideburner Valve Cup. 4154476
GG	1	Sideburner Ignitor Wire 5156110
HH	1	Grill Bottom 4508387
II	3	Burner 5068016
JJ	1	Left Shelf Assembly . . 4520016
KK	1	Sideburner Assembly . 4520018
LL	1	Sideburner Burner . . . 5068017
MM	1	Grill Lid 4570044
--	1	Grill Cover. 4985710
NN	1	Rotisserie Knob 4154214
OO	1	Sideburner Knob. 4154471
PP	3	Control Knob 4154507
QQ	1	Heat Indicator 4157142
RR	1	AAA Battery 4153177
SS	1	Button 4157156
--	1	Hardware, Cart Assy. . 4254009
--	1	Hardware, Shelf 4254012
--	1	Hardware, Swing Grid. 4254018
TT	1	Shield 4501356
UU	1	Grease Clip. 5156607

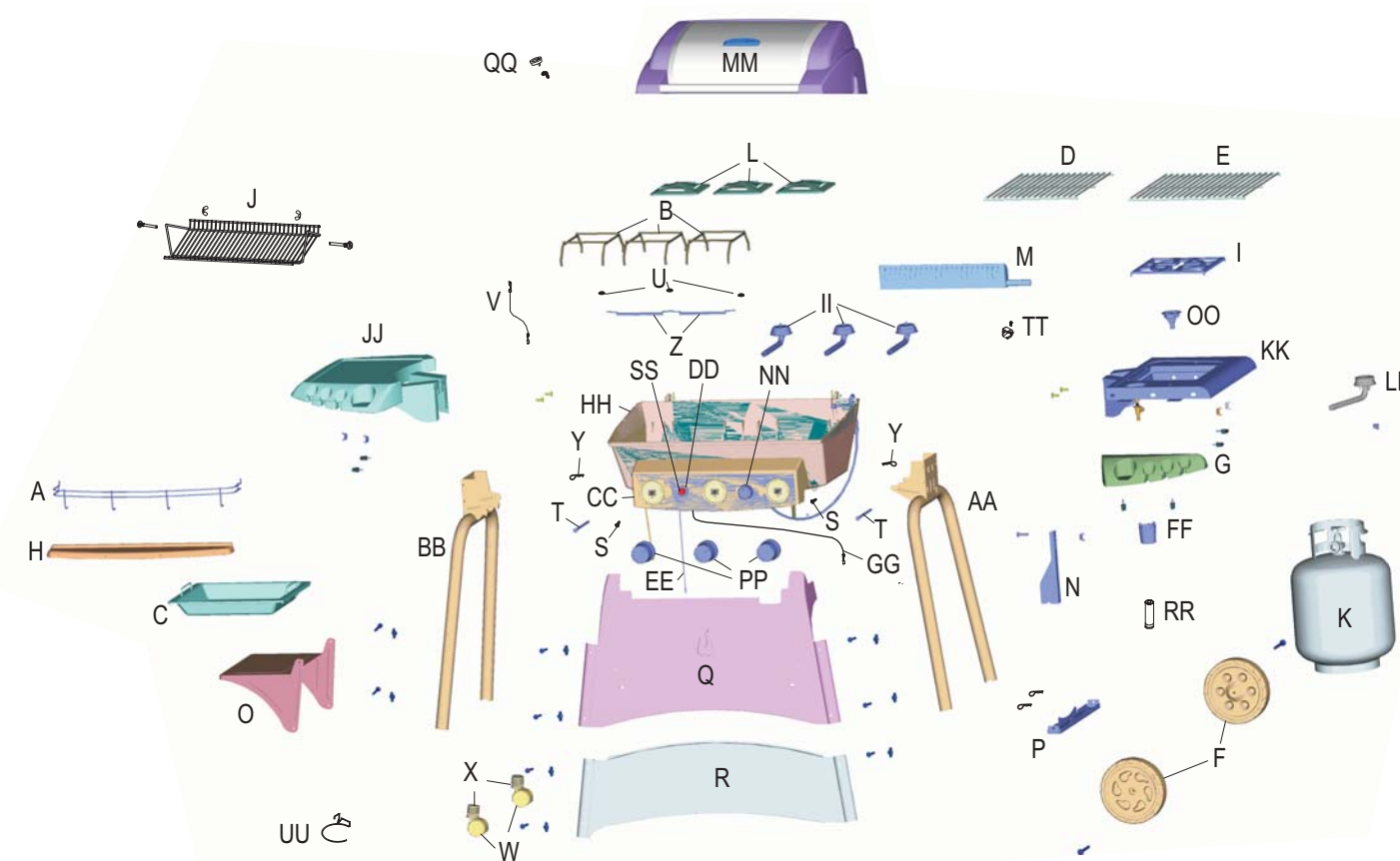

NO TOOLS REQUIRED

the Big Easy
THE GRILL THAT COOKS
BREAKFAST LUNCH AND DINNER

the Big Easy

4638263
ASSEMBLY MANUAL



THIS GRILL IS FOR OUTDOOR USE ONLY

CAUTION: Read and follow all safety statements, assembly instructions, and use and care directions before attempting to assemble and cook.

INSTALLER/ASSEMBLER: Leave these instructions with consumer.

CONSUMER: Keep this manual for future reference.

WARNING

Failure to follow all manufacturer's instructions could result in serious personal injury and/or property damage.

CAUTION

Some parts may contain sharp edges – especially as noted in the manual! Wear protective gloves if necessary.

If you have any questions or need assistance during assembly, please call 1-800-241-7548.

Visit us on the web at:
www.charbroil.com

